

GY5335 EZ Moxa Starter Deluxe

The EZ Moxa Starter Deluxe is a 4" x 2" stand-type butane lighter that lights moxa sticks quickly and easily, eliminating the need for traditional lighters or matches. Even smokeless moxa sticks (which typically take longer to light) are lit in a matter of seconds. The torch is easily ignited by pushing a button, and can be refilled with butane gas as needed. The Starter is finished with a clear chamber that allows the butane level to be easily monitored. Made in China.

1. Remove the cap before attempting to ignite the Starter.
2. Be sure the locking switch located on the side of the upper black housing is toggled to the off (or left) position and press the Starter button. If a hands-free continuous flame is desired, toggle the locking switch to the on (or right) position after the Starter is ignited. If the hands-free feature is used, please be sure the locking switch is toggled to the off position and the flame is extinguished when you are finished using the Starter.
3. The flame intensity can be adjusted by turning the dial located on the bottom of the Starter. Please note that upon initial ignition of the Starter, the intensity dial can not be set to the minimum level or the Starter will not ignite.



Cap

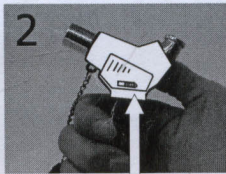

Locking switch

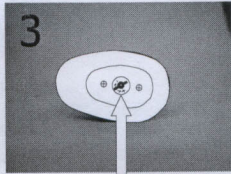

Intensity dial